

STOP GLOBE VALVE ACID-PROOF TYPE ZSA320

CHARACTERISTIC:

Diameter	-	6-10mm;
Pressure	-	320 bar;
Temperature	-	up to 250°C for acids, bases and other aggressive media;
	-	up to 550°C for non-toxic media;
Medium	-	acids, liquors, water, steam and other non-toxic and non aggressive liquid and gas media, engine fuel.

VERSIONS:

type / ends / body material / disc and disc ring / drive type

Example: ZSA320 / --- / ---

Example: ZSA320 / L / ---

Type - body material	Sign	Ends	Sign	Disc and disc ring	Sign	Others	Sign
X6CrNi18-10 or GX5CrNi19-10	ZSA320	Standard	---	Standard	---	-----	---
X2CrNiMo17-12-2 or GX5CrNiMo19-11-2	ZSB320			Stellit	L		

APPLICATION:

Stop globe valve (**ZSA320**) is designed to open and stop the flow. The valve is not supposed to be used as a regulating device. For regulation the version with throttling plug should be applied.

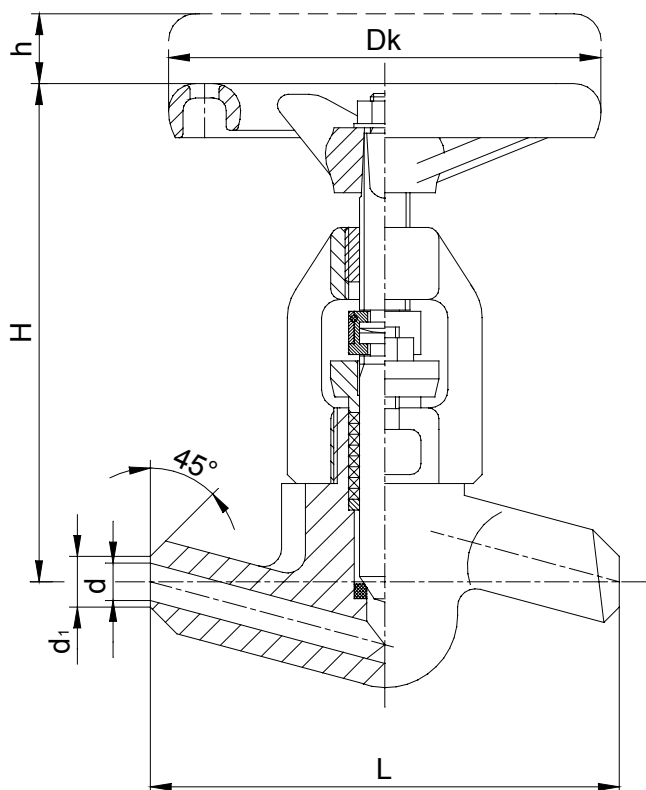

WK



FABRYKA ARMATURY PRZEMYSŁOWEJ

„WAKMET” spółka jawna

Kaczmarek, Krzywdziński, Wachowski, Wilczyński

Bodzanów 75 48-340 GŁUCHOŁAZY 1

tel. +48(077) 439-40-20, fax +48(077) 439-18-72

e-mail: wakmet@wakmet.com.pl

http: www.wakmet.com.pl

MATERIALS:

Versions	ZSA320	ZSB320
Parts	DN 6-10	
Body, bonnet	X6CrNiTi18-10 (1.4541)	X2CrNiMo17-12-2 (1.4404)
Disc	X6CrNiTi18-10 (1.4541)	X2CrNiMo17-12-2 (1.4404)
Stem	X6CrNiTi18-10 (1.4541)	X2CrNiMo17-12-2 (1.4404)
Packing rings, gasket	Grafit	
Wheel	Cast iron	

Special materials on request; modifications reserved.

DIMENSIONS:

DN	d	d ₁	d ₂	M	L	H	h	Dk	Weight
6	6	8	12	M27 x 2	160	150	12	100	2,50
8	8	12	16	M27 x 2	160	150	12	100	2,50
10	10	14	18	M27 x 2	160	150	12	100	2,50

Dimensions in mm; modifications reserved.

TECHNICAL DATA:

Body material	Medium	PN	Nominal working pressure at working temperature															
			20°C	100°C	150°C	200°C	250°C	300°C	350°C	400°C	450°C	480°C	500°C	510°C	520°C	530°C	540°C	550°C
		bar																
X6CrNiTi18-10 (1.4541)	Aggressive media	320	320	317	299	283	270	-	-	-	-	-	-	-	-	-	-	-
X6CrNiTi18-10 (1.4541)	Non Aggressive media	320	320	317	299	283	270	254	245	238	232	230	227	226	226	225	224	216

MOUNTING AND OPERATING:

The valve can only be mounted and operated by skilled, properly trained and qualified personnel. Incorrect assembly or operation of the valve may have substantial impact on the entire system such as fluid leakage, reduction in system's function etc.

Before a valve is installed the pipeline must be clean from any mechanical impurities. The compatibility of critical parameters of the flow must be checked with the parameters of the valve. Stop globe valve can be mounted to a pipe-line in any position. The direction of flow should only comply with the arrow marked on the body. The valve should be operated strictly with its assign. In order to provide valve's reliability the following suggestions must be observed:

- medium flowing through the valve is supposed to be clean out of any mechanical impurities;
- the valve must be protected from any mechanical damages during its work;
- nominal parameters marked on the valve must be observed.