

HCVA4 Valve

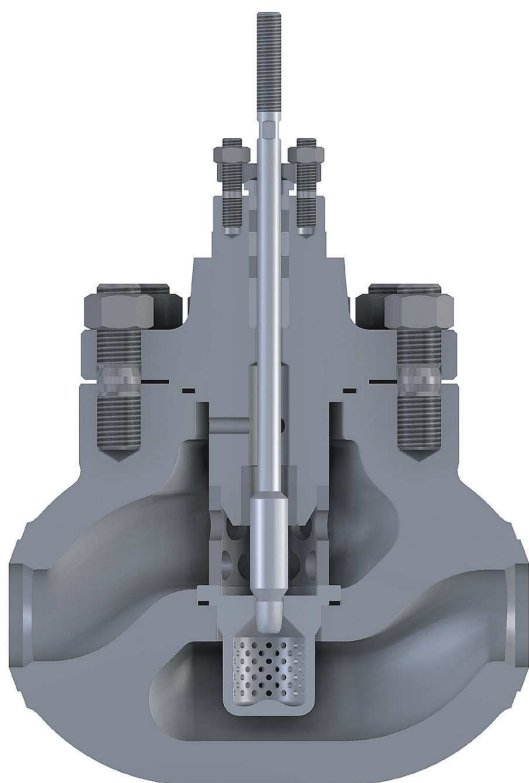

Application

Regulatory valve of HCVA4 type is ready to perform with heavy erosive media. It is suitable to control the highly demanding parameters, also during infinite critical conditions. HCVA4 valves are used in any process of continuous desalination of the boiler. Their performance suits flashing environs and high pressure drops.

Description

HCVA4 is straightway valve. Basically, it consists of body topped by the bonnet, of a plug with a stem driven through guide bushing, and of the seat with anti-flashing bushing fixed by construction cage. Both the bonnet and the seat are sealed with graphite spiral wound gaskets (placed in channel). Thus, disassembly and assembly of the valve are easy and do not require any special tools. Liquid medium goes to the plug, then evaporates in anti-flashing bushing vents. Thanks to dispersion of kinetic energy of the water-steam mixture the valve's body does not undergo the substantial erosion. There are two types of plug available: profiled or perforated. HCVA4 valve works with media flow directed over the plug.

Technical data

Nominal diameter	DN15÷DN300			
Nominal pressure	PN10÷PN400			
Connections	bolted flanges; welding ready			
Flow coefficient Kvs	0,1÷1300 m ³ /h			
Body	1.0460 (P250GH)	1.5419 (G20Mo5)	1.4308 (GX5CrNi19-10)	1.4903 (X10CrMoVNB9-1)
	1.0619 (GP240GH)	1.7357 (G17CrMo5-5)	1.4408 (GX5CrNiMo19-11-2)	1.4901 (X10CrWMoVNB9-2)
	1.5415 (16Mo3)	1.4541 (X6CrNiTi18-10)	1.7380 (10CrMo9-10)	1.7379 (G17CrMo9-10)
	1.7335 (13CrMo4-5)	1.4404 (X2CrNiMo17-12-2)	1.7715 (14MoV6-3)	1.6368 (15NiCuMoNb5-6-4)
Plug	1.4541 (X6CrNiTi18-10)	1.4057 (X17CrNi16-2)	1.4125 (X105CrMo17)	titanium BT-9
Seat	1.4541 (X6CrNiTi18-10)	1.4057 (X17CrNi16-2)	1.4125 (X105CrMo17)	titanium BT-9
Stem	1.4057 (X17CrNi16-2)	1.4923 (X22CrMoV12-2)		
Cage	1.4057 (X17CrNi16-2)			
Hardening of the inner parts	stellite; nitriding; hardening			
Rangeability	50:1			
Leakage class	metal/metal sealing – IV (standard); V (improved)			
Body's gland	spiral, metal+graphite			
Seal bushing	graphite; PTFE			

INTEC

Industrial Automatics Enterprise INTEC Ltd. Co.
ul. Baczałlego 54, 51-649 Wrocław, Poland
tel./fax: +48 71 348 18 18, e-mail: biuro@intec.com.pl
www.intec.com.pl

WK

WAKMET Industrial Valves Factory Utd.
Bodzanów 75, 48-340 Gliucholazy 1, Poland
tel./fax: +48 77 439 40 20, e-mail: wakmet@wakmet.com.pl
www.wakmet.com.pl